

CABINET

PLANNING GUIDE

For Assistance Call:

984.213.5147 984.401.9622 984.310.0070
Gary Wake Forest Clayton

Email: newcabinets@trianglerestores.org

Customer Info

First Name: _____

Last Name: _____

Email: _____

Phone: _____

About Your Space

Ceiling Height: _____

Wall Cabinet Height: _____

If Applicable

Soffit Height: _____

Soffit Depth: _____

**Are there any other limitations?
(Plumbing, Electric, Flooring, etc.)**

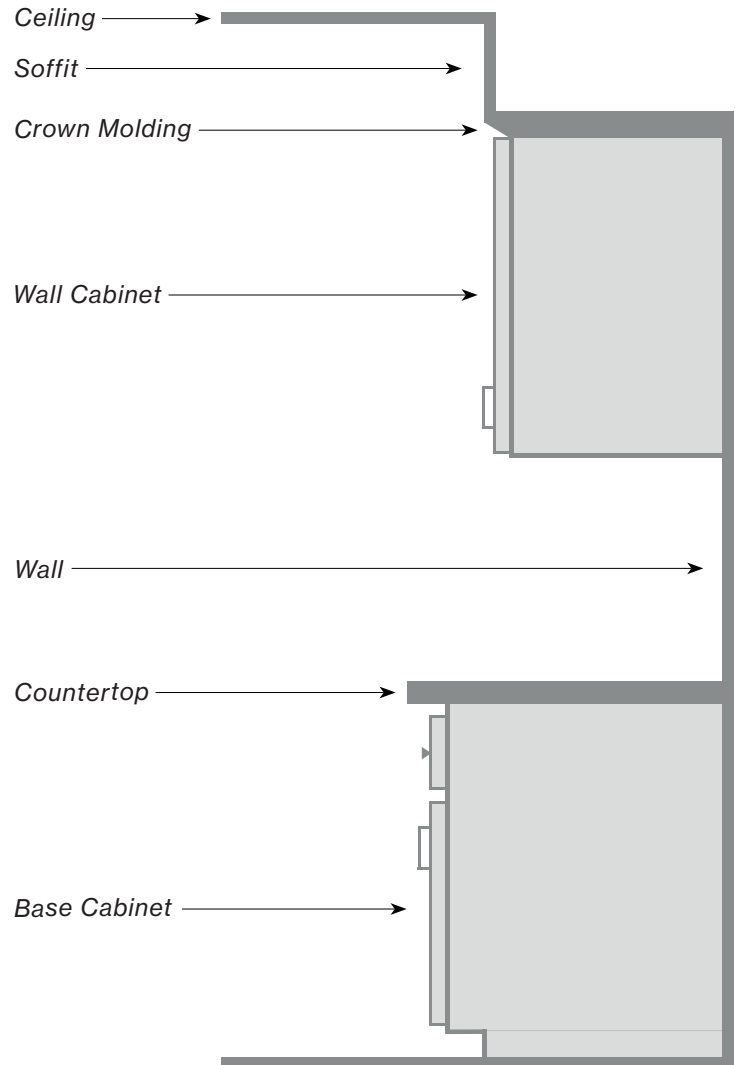

Your New Kitchen

Primary Door Style & Finish: _____

Secondary Door Style & Finish: _____

Please check any extras you prefer:

- | | |
|---|---|
| <input type="checkbox"/> Wine Storage | <input type="checkbox"/> Cutlery Divider |
| <input type="checkbox"/> Plate Rack | <input type="checkbox"/> Light Rail Molding |
| <input type="checkbox"/> Crown Molding | <input type="checkbox"/> Garbage Pull Out Cabinet |
| <input type="checkbox"/> Open Shelves | <input type="checkbox"/> Spice Pull Out Cabinet |
| <input type="checkbox"/> Roll Out Trays | <input type="checkbox"/> Crown Molding to Ceiling |
| <input type="checkbox"/> Glass Doors | <input type="checkbox"/> Microwave Upper Cabinet |
| <input type="checkbox"/> Lazy Susan | <input type="checkbox"/> Microwave Base Cabinet |
| <input type="checkbox"/> Wood Hood | <input type="checkbox"/> Wide Storage Drawer(s) |
| <input type="checkbox"/> Base Molding | <input type="checkbox"/> Decorative Door Panels |

Drawing Your Floor Plan



Use a pencil and the graph below to design your new kitchen.

How to Measure

Tip: Pick a corner to start. Then measure the full length of the wall. Continue around the whole room.



Be sure to measure from the outside of the trim edge to the far wall.



Make sure that all your measurements add up to the overall wall measurements.

Mark all your measurements in inches only, so 7'6" should be marked as 90".

Indicate the direction of the door swing.

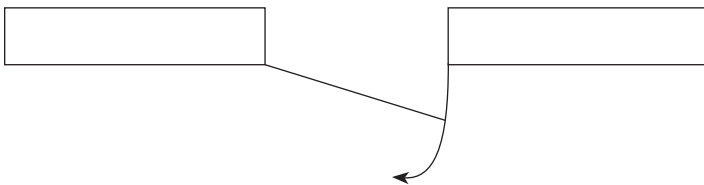

Measure all objects on the wall (includes windows, doors, AC vents, electrical outlets, ventilation duct work, gas lines).

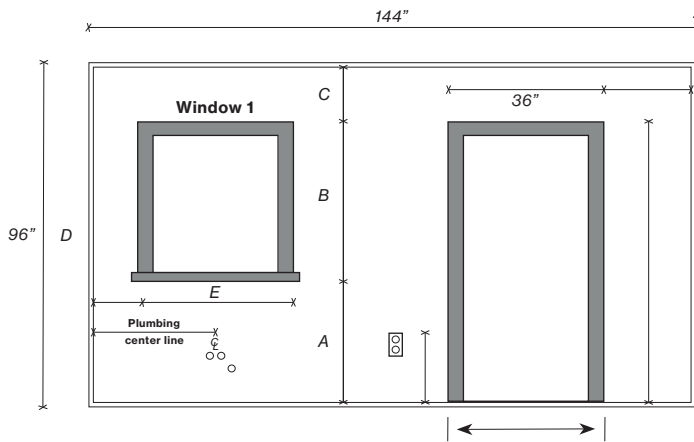

Measure all the window and door openings from outside trim edge to outside trim edge.

Window Measurements

Name/Location Width Height Distance from floor

Name/Location	Width	Height	Distance from floor

Appliances in New Kitchen

In order to do a complete design we will need to know the exact sizes of all the appliances that are going to be used in the new kitchen. **If you have any manufacturer model numbers, please fill in below.**

Range

Brand/Model	Width	Depth	Height
or			

Cook-top

Brand/Model	Width	Depth	Height
or			

Oven

Brand/Model	Width	Depth	Height
or			

Hood

Brand/Model	Width	Depth	Height
or			

Microwave

Brand/Model	Width	Depth	Height
or			

Refrigerator

Brand/Model	Width	Depth	Height
or			

Dishwasher

Brand/Model	Width	Depth	Height
or			

Other

Brand/Model	Width	Depth	Height
or			

Appliances in New Kitchen

If unable to provide model numbers, please answer the following questions:

Cooktop or range?

Over the range:

Stainless steel hood to the ceiling? Yes No

Hood under wall cabinet? Yes No

Wood hood? Yes No

Microwave? Yes No

If double-oven and separate microwave, where would you prefer the microwave?

Sink:

Under-mount or apron-front sink?

Additional Information

Is this project a renovation or new construction?

If new construction, which phase is the project in?

For new construction, we provide an initial design and quote to plan for plumbing, electric and budget. Walls should be remeasured once in place. Ideally, final revisions will be submitted about two weeks before ordering.

Additional Questions/Notes

Draw Your Floor Plan



Transfer all information to the design grid and **include actual measurements in inches.**

